

2025 BASE MAP

THE NATOMAS BASIN CONSERVANCY

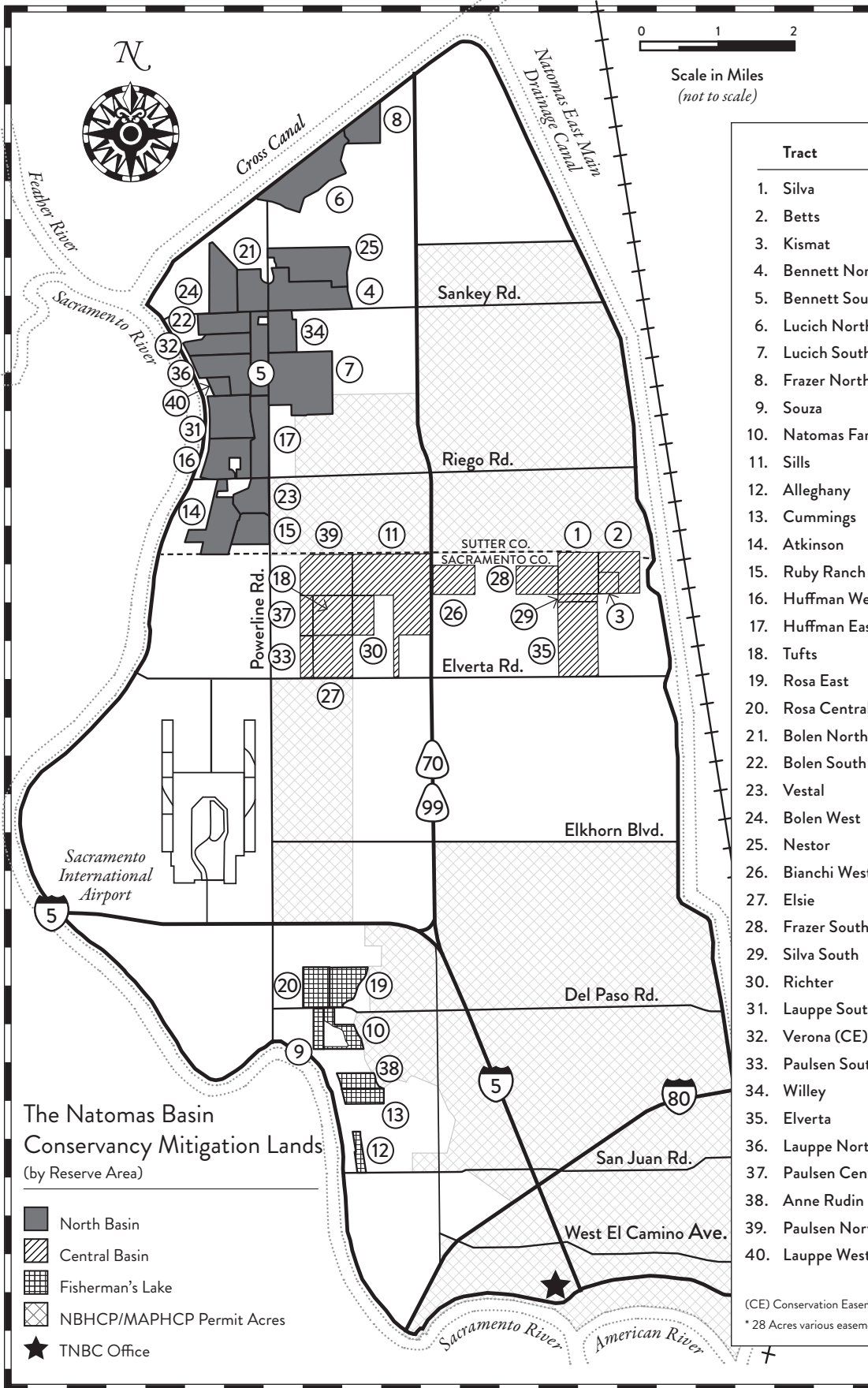

All acreage is approximate.

Tract	Acq. Date	Acres
1. Silva	01.07.99	159
2. Betts	04.05.99	136
3. Kismat	04.16.99	40
4. Bennett North	05.17.99	227
5. Bennett South	05.17.99	132
6. Lucich North	05.18.99	268
7. Lucich South	05.18.99	352
8. Frazer North	07.31.00	93
9. Souza	07.02.01	40
10. Natomas Farms	07.09.01	55
11. Sills	07.15.02	436
12. Alleghany	11.07.02	30
13. Cummings	11.07.02	56
14. Atkinson	06.12.03	182
15. Ruby Ranch	06.23.03	91
16. Huffman West	09.30.03	158
17. Huffman East	09.30.03	136
18. Tufts	09.29.04	148
19. Rosa East	03.23.05	106
20. Rosa Central	03.23.05	100
21. Bolen North	04.29.05	114
22. Bolen South	04.29.05	102
23. Vestal	09.12.05	95
24. Bolen West	09.01.06	155
25. Nestor	09.01.06	233
26. Bianchi West	11.07.06	110
27. Elsie	11.07.06	158
28. Frazer South	11.07.06	110
29. Silva South	09.28.12	29
30. Richter	01.03.20	81
31. Lauppe South	06.30.20	172
32. Verona (CE)	07.02.20	117
33. Paulsen South	09.28.20	52
34. Willey	10.19.20	108
35. Elverta	07.13.21	288
36. Lauppe North	01.05.22	185
37. Paulsen Central	08.12.22	49
38. Anne Rudin Preserve	02.28.23	53
39. Paulsen North	10.10.24	203
40. Lauppe West	01.10.25	14
		5,374*

(CE) Conservation Easement
 * 28 Acres various easements. Total with easements 5,402.